

ACCESSIBILITY DETAILS FOR RAMPS, STAIRS & ELEVATORS

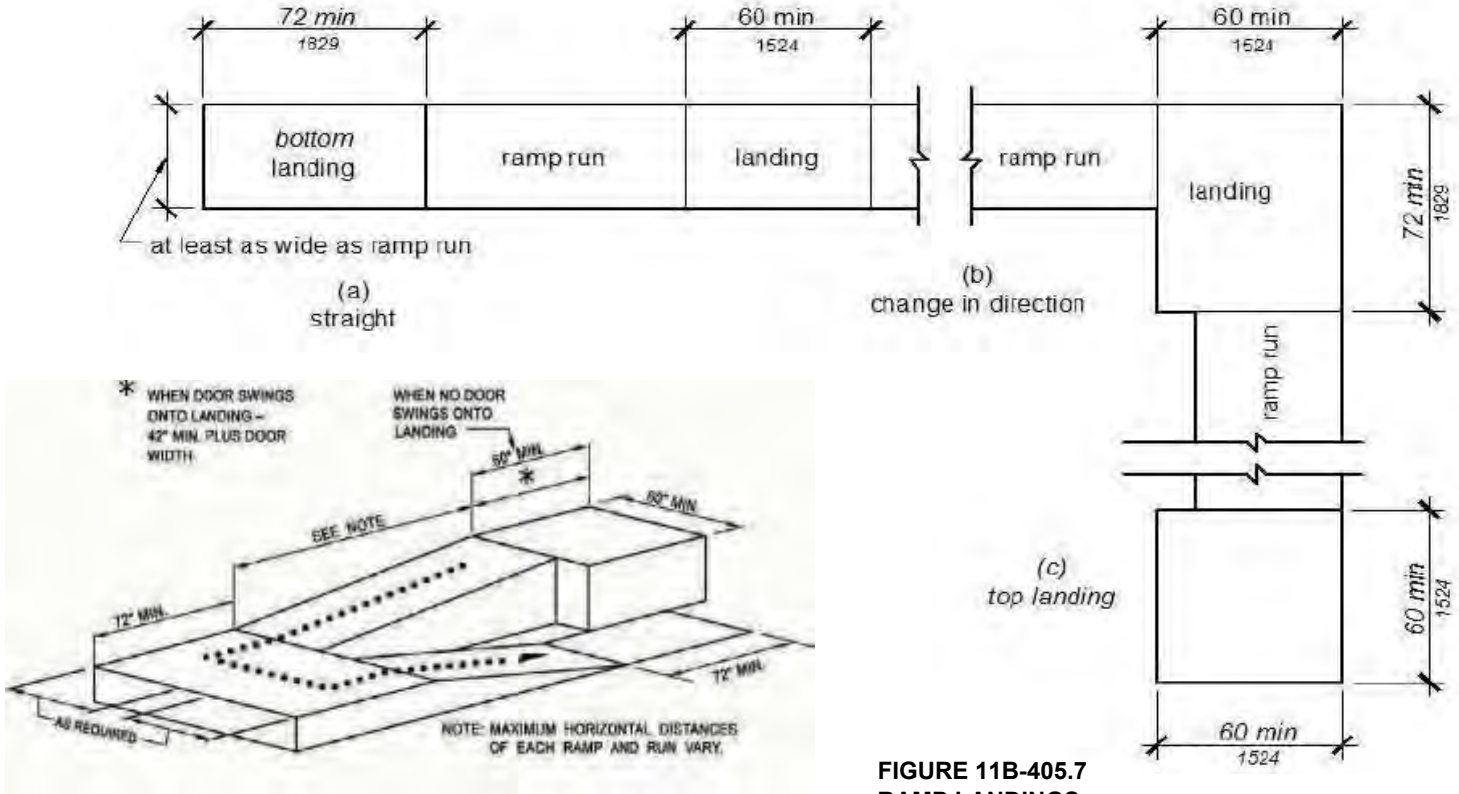
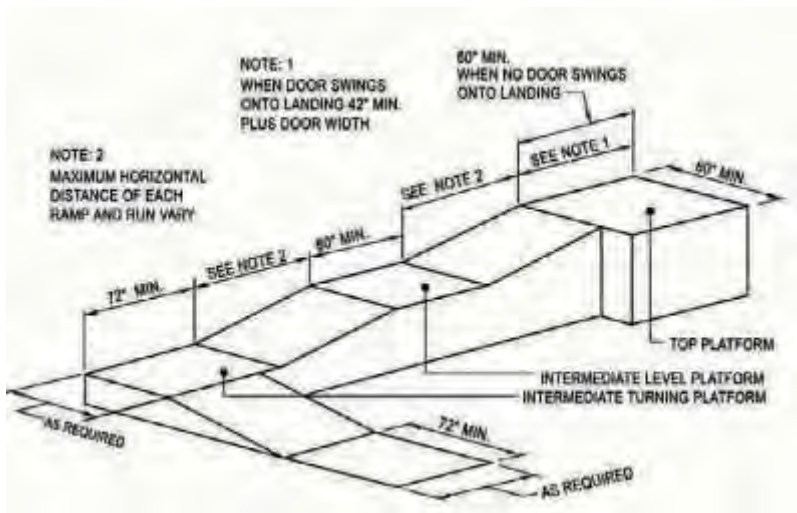
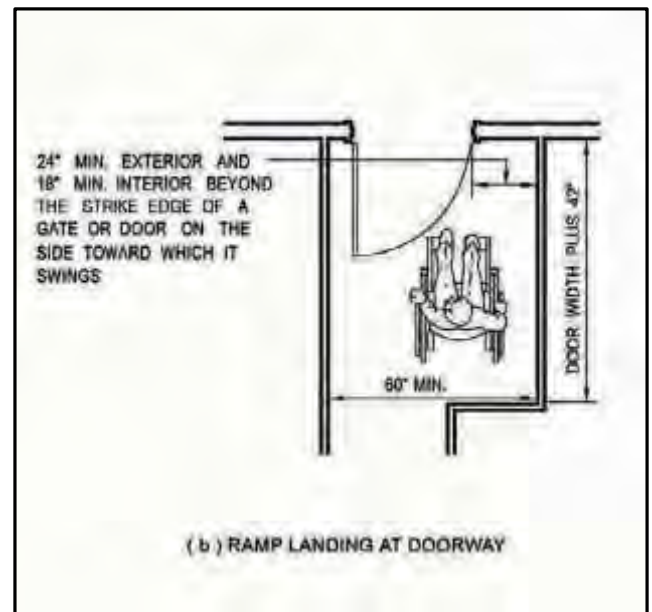

FIGURE 11B-405.7 RAMP LANDINGS

RAMP WITH INTERMEDIATE SWITCH-BACK PLATFORM



RAMP WITH TURNING PLATFORM



RAMP LANDING AND DOORWAY

THESE DIAGRAMS ILLUSTRATE THE SPECIFIC REQUIREMENTS OF THESE REGULATIONS AND ARE INTENDED ONLY AS AN AID FOR BUILDING DESIGN AND CONSTRUCTION.

THESE DIAGRAMS ILLUSTRATE THE SPECIFIC REQUIREMENTS OF THESE REGULATIONS AND ARE INTENDED ONLY AS AN AID FOR BUILDING DESIGN AND CONSTRUCTION.

RAMPS

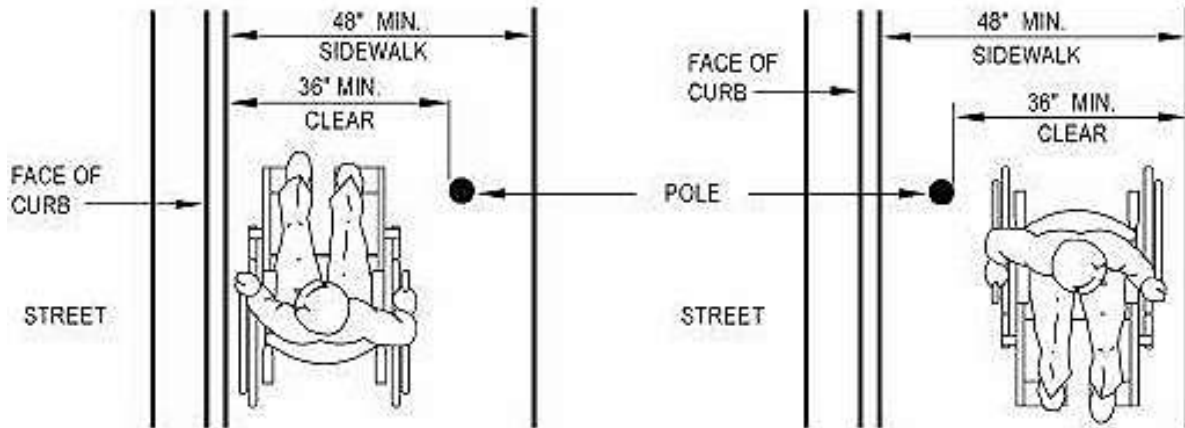

SIDEWALK OBSTRUCTIONS

11B-505.10.1 TOP AND BOTTOM EXTENSION AT RAMPS.
 Ramp handrails shall extend horizontally above the landing for 12 inches beyond the top and bottom of ramp runs. Extensions shall return to a wall, guard, or landing surface, or shall be continuous to the handrail of an adjacent ramp run.

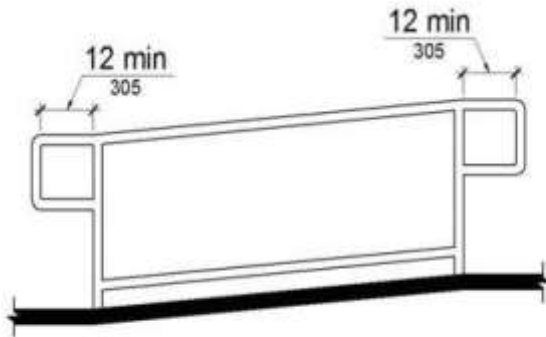

**FIGURE 11B-505.10.1
 TOP AND BOTTOM HANDRAIL EXTENSION AT RAMPS**

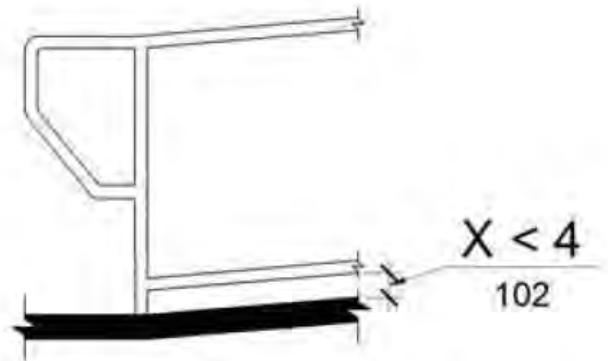

**FIGURE 11B-405.9.2
 CURB OR BARRIER EDGE PROTECTION**

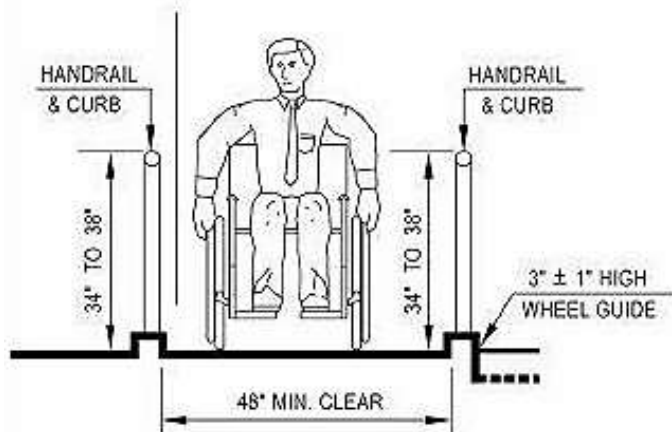

(c) WHEEL GUIDE

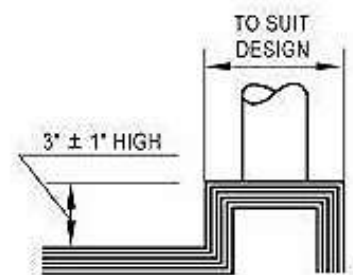

WHEEL GUIDE DETAIL

RAMPS AND HANDRAILS

THESE DIAGRAMS ILLUSTRATE THE SPECIFIC REQUIREMENTS OF THESE REGULATIONS AND ARE INTENDED ONLY AS AN AID FOR BUILDING DESIGN AND CONSTRUCTION.

DOORWAYS AT RAMP LANDINGS

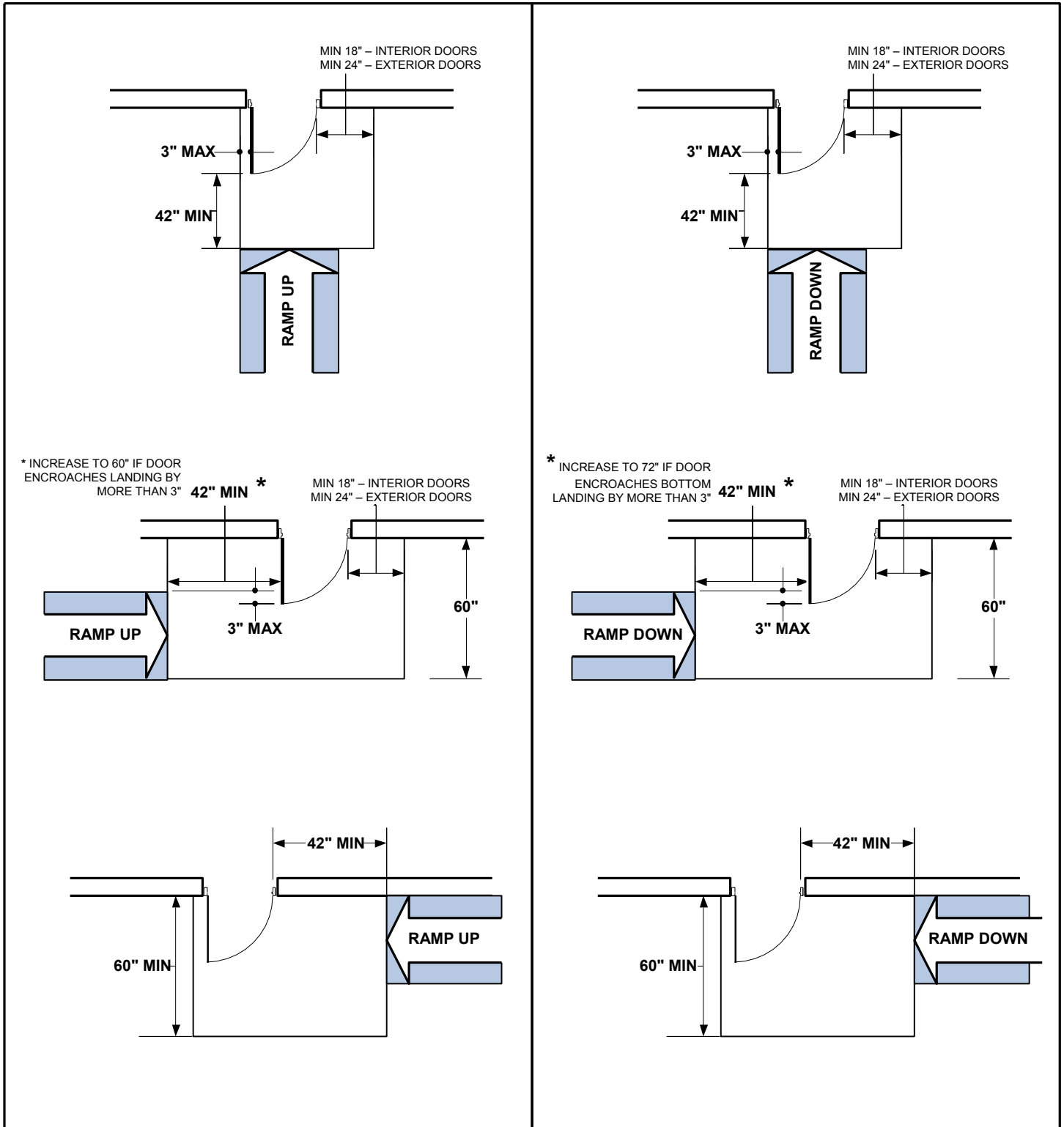

**DOORWAYS AT TOP LANDING
SPACE OF A RAMP**

**DOORWAYS AT BOTTOM LANDING
SPACE OF A RAMP**

THESE DIAGRAMS ILLUSTRATE THE SPECIFIC REQUIREMENTS OF THESE REGULATIONS AND ARE INTENDED ONLY AS AN AID FOR BUILDING DESIGN AND CONSTRUCTION.

STAIRWAYS

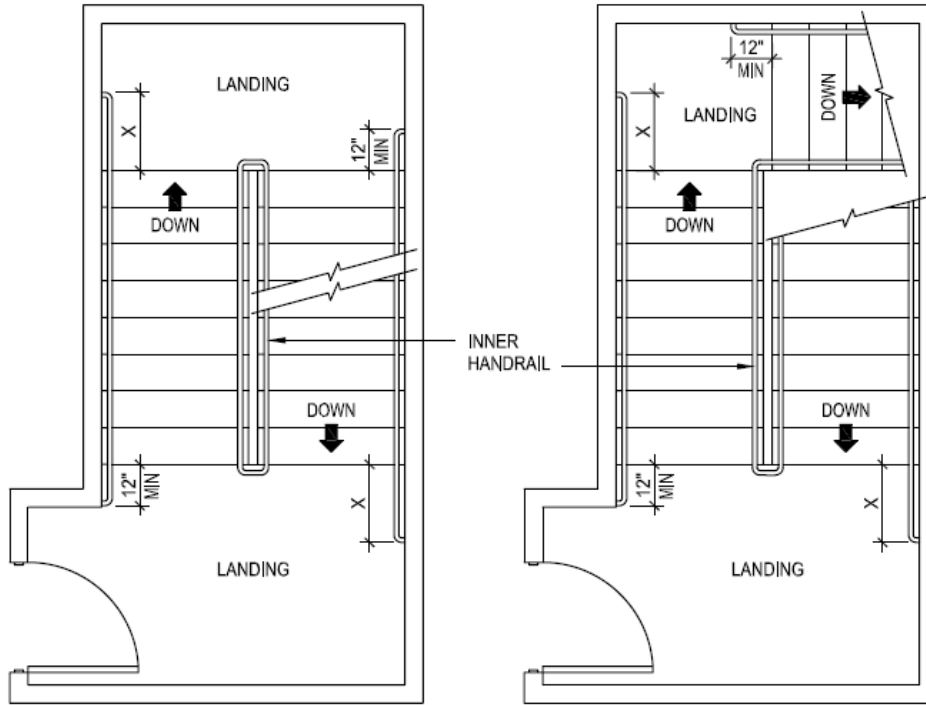

NOTE: INNER HANDRAIL AT LANDINGS OF STAIRS THAT DOUBLE BACK OR IMMEDIATELY TURN SHALL BE CONTINUOUS AND SHALL NOT EXTEND INTO LANDING OR ACCESSIBLE ROUTE OF TRAVEL

X = EXTENSION OF HANDRAIL SHALL BE EQUAL TO THE TREAD WIDTH PLUS 12 INCHES MINIMUM

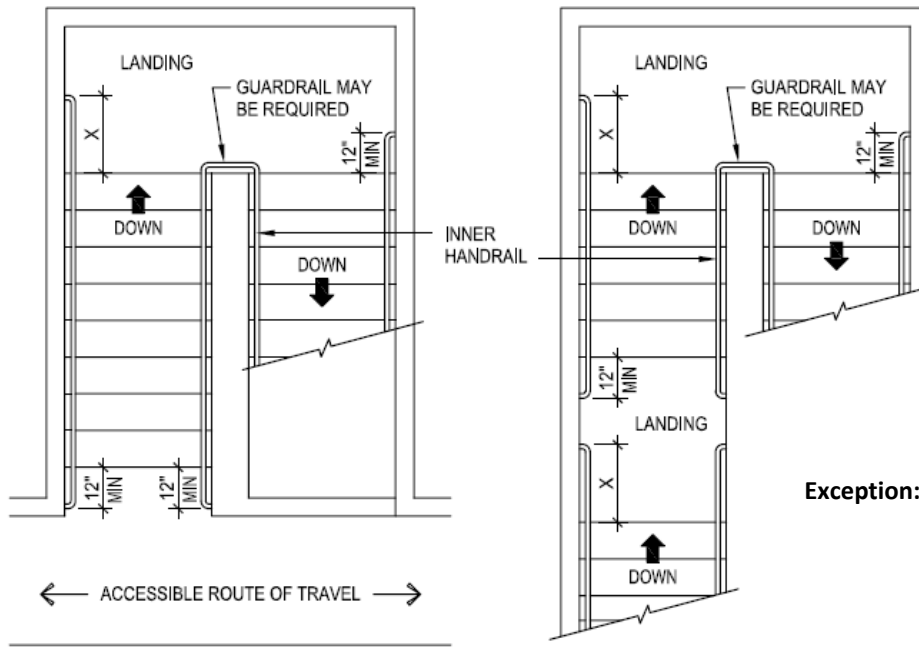

Exception: Curved stairways with winder treads are permitted at stairs which are not part of a required means of egress.

11B-504 STAIRWAYS

THESE DIAGRAMS ILLUSTRATE THE SPECIFIC REQUIREMENTS OF THESE REGULATIONS AND ARE INTENDED ONLY AS AN AID FOR BUILDING DESIGN AND CONSTRUCTION.

STAIRS

**RADIUS 1/2" MAX
(12.7MM)**

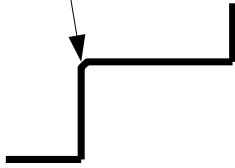

**(a) RADIUS OF TREAD EDGE
(TYPICAL FOR ALL PROFILES)**

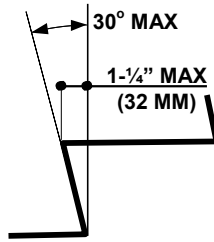

(b) ANGLED RISER

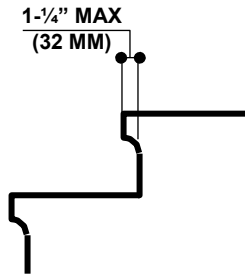

(c) CURVED NOSING

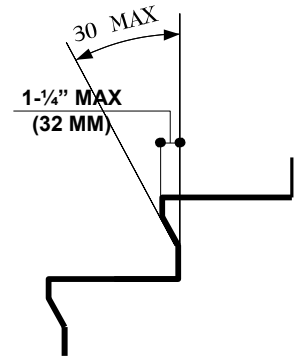

(d) BEVELED NOSING

**FIGURE 11B-504.5
STAIR NOSINGS**

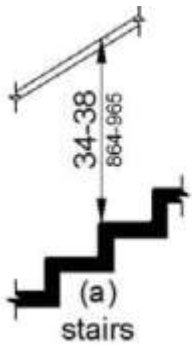

**(a)
stairs**

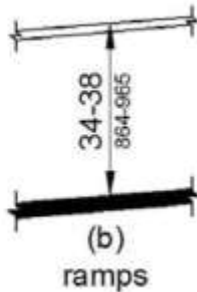

**(b)
ramps**

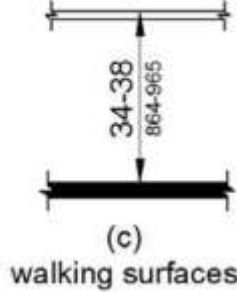

**(c)
walking surfaces**

**FIGURE 11B-505.4
HANDRAIL HEIGHT**



**FIGURE 11B-505.5
HANDRAIL CLEARANCE**



**FIGURE 11B-505.6
HORIZONTAL PROJECTIONS
BELOW GRIPPING SURFACE**

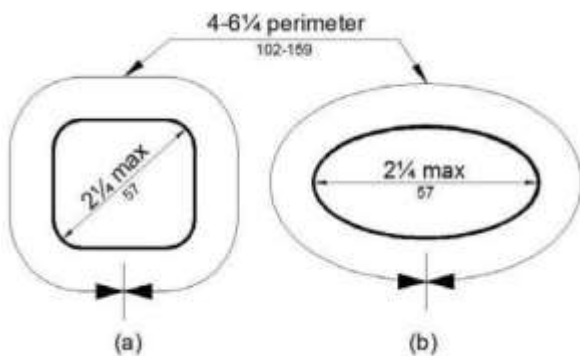

(a)

(b)

**FIGURE 11B-505.7.2
HANDRAIL NON-CIRCULAR CROSS
SECTION**

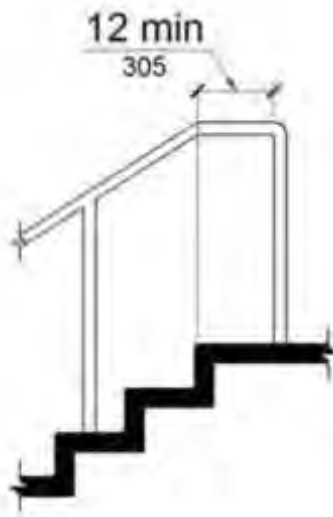

**FIGURE 11B-505.10.2
TOP HANDRAIL EXTENSION
AT STAIRS**

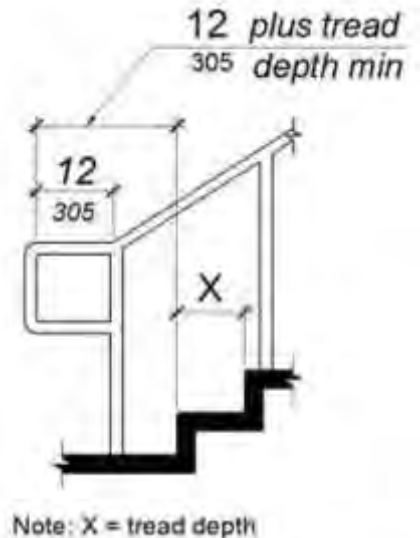

Note: X = tread depth

**FIGURE 11B-505.10.3
BOTTOM HANDRAIL EXTENSION
AT STAIRS**

ELEVATORS

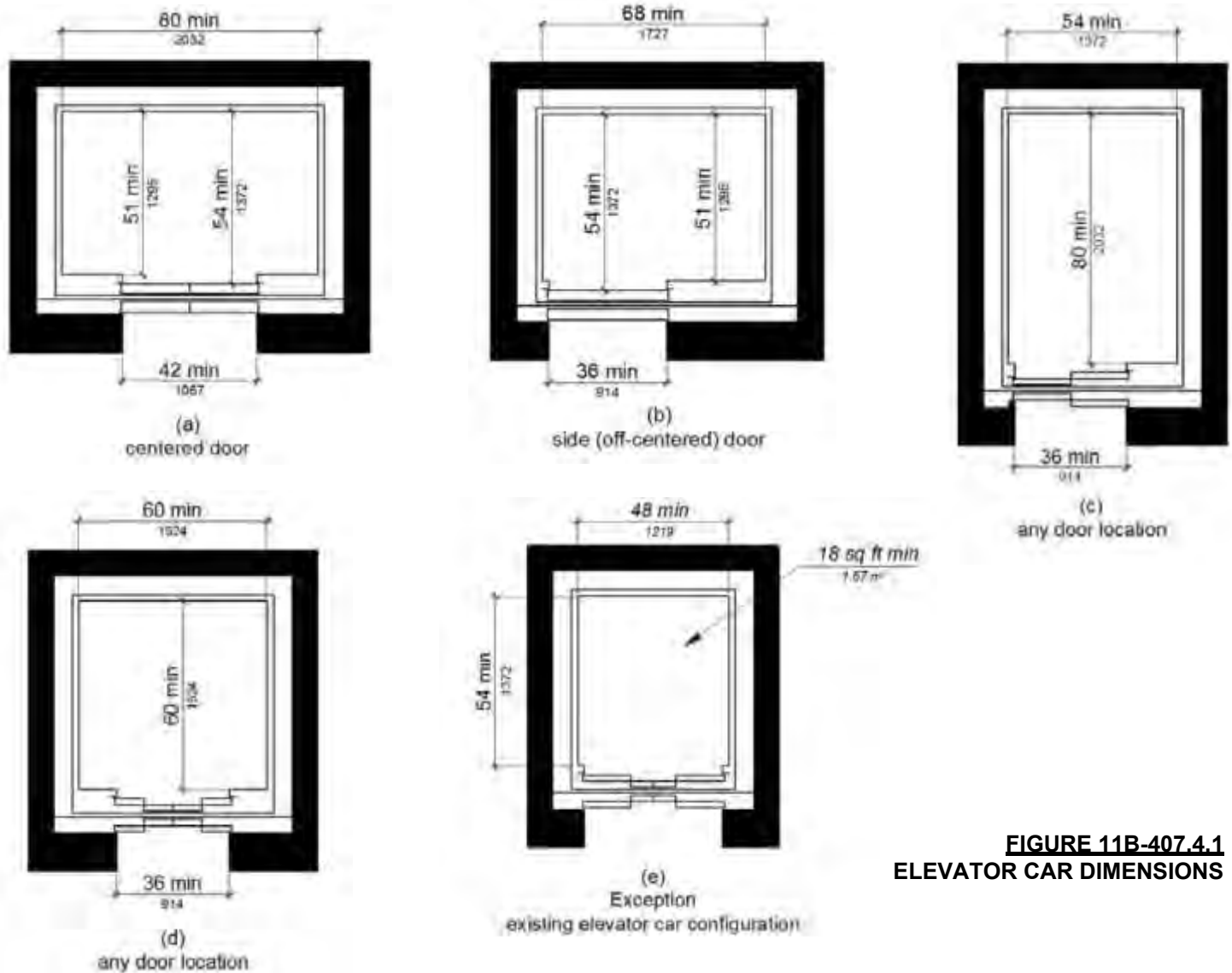

**FIGURE 11B-407.4.1
 ELEVATOR CAR DIMENSIONS**

**TABLE 11B-407.4.1
 ELEVATOR CAR DIMENSIONS**

MINIMUM DIMENSIONS				
DOOR LOCATION	DOOR CLEAR WIDTH	INSIDE CAR, SIDE TO SIDE	INSIDE CAR, BACK WALL TO FRONT RETURN	INSIDE CAR, BACK WALL TO INSIDE FACE OF DOOR
Centered	42 inches	80 inches	51 inches	54 inches
Side (off-centered)	36 inches	68 inches	51 inches	54 inches
Any	36 inches	54 inches	80 inches	80 inches
Any	36 inches	60 inches	60 inches	60 inches

1. A tolerance of minus 5/8 inch (15.9 mm) is permitted.
2. Other car configurations that provide a turning space complying with Section 11B-304 with the door closed shall be permitted.

ELEVATORS

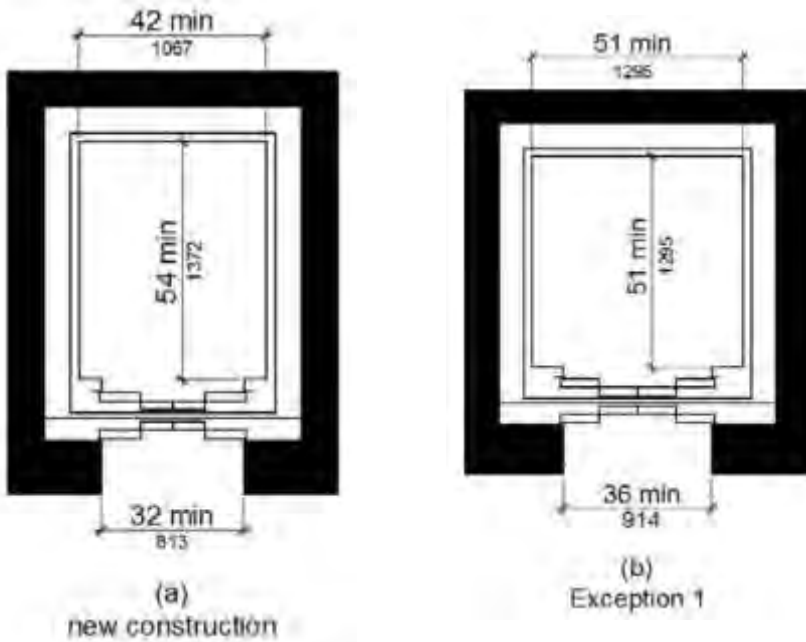

**FIGURE 11B-408.4.1
LIMITED-USE/LIMITED-APPLICATION (LULA)
ELEVATOR CAR DIMENSIONS**

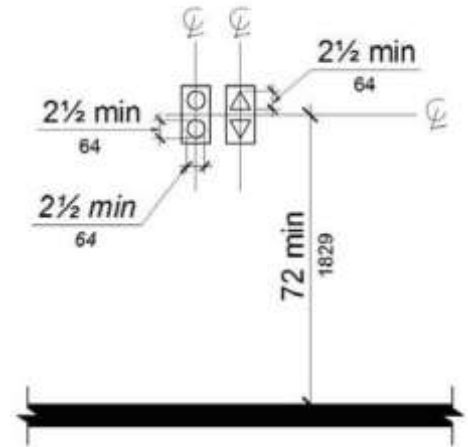

**FIGURE 11B-407.2.2.2
VISIBLE HALL SIGNALS**

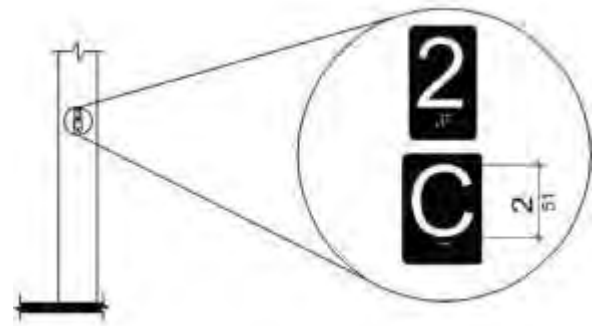

**FIGURE 11B-407.2.3.2
CAR DESIGNATIONS ON JAMBS OF
DESTINATION-ORIENTED ELEVATOR HOISTWAY
ENTRANCES**

Door and signal timing. The minimum acceptable time from notification that a car is answering a call or notification of the car assigned at the means for the entry of destination information until the doors of that car start to close shall be calculated from the following equation:

$T = D(1.5 \text{ ft/s})$ or $T = D(455 \text{ mm/s}) = 5$ seconds minimum where T equals the total time in seconds and D equals the distance (in feet or millimeters) from the point in the lobby or corridor 60 inches (1524 mm) directly in front of the farthest call button controlling that car to the centerline of its hoistway door. (11B-407.3.4)

Exceptions:

1. For cars with in-car lanterns, T shall be permitted to begin when the signal is visible from the point 60 inches (1524 mm) directly in front of the farthest hall call button and the audible signal is sounded.
2. Destination-oriented elevators shall not be required to comply with Section 11B-407.3.4.

Door delay. Elevator doors shall remain fully open in response to a car call for 5 seconds minimum. (11B-407.3.5)

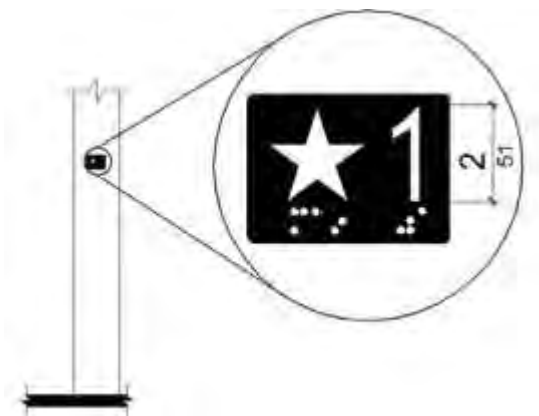

**FIGURE 11B-407.2.3.1
FLOOR DESIGNATIONS ON JAMBS OF
ELEVATOR HOISTWAY ENTRANCE**